

BUTZ FAMILY OF COMPANIES

HISTORY

The Butz family has a long, storied tradition of completing high-quality projects in the Lehigh Valley dating back to the mid-1800s, when the family constructed covered bridges. Alvin H. Butz, Inc. was the first to pioneer the Construction Management concept in the Lehigh Valley in 1973.

In 2003, two new construction management companies, Alexander Building Construction Co. and Shoemaker Construction Co., were formed and together as The Butz Family of Companies, we provide construction management services in Pennsylvania, New Jersey, New York, Delaware and Maryland.



ALVIN H. BUTZ, INC. has been continuously owned and operated in the Lehigh Valley by the Butz family, with the 6th generation in line to preserve the tradition and reputation of the organization.

MISSION

THE BUTZ FAMILY OF COMPANIES is dedicated to superior project delivery in an atmosphere of **teamwork** and open **communication** in all of our business relationships.

We will build on our tradition of **excellence** with an unwavering **commitment to quality** and **continuous improvement**.

We will always perform with **integrity, honesty, reliability, and enthusiasm**.

We will ensure **growth** opportunities for our employees and a continued commitment to our **community**.

30+ consecutive years
ENR Top 400 Contractors

3-YEAR AVERAGE VOLUME **\$1.02B**

200+
EMPLOYEES

10 ASHE HEALTHCARE
CERTIFICATE
HOLDERS

12 LEED
ACCREDITED
PROFESSIONALS

EXPERIENCE

10-YEAR
500+
PROJECTS
>\$4.0B
VOLUME

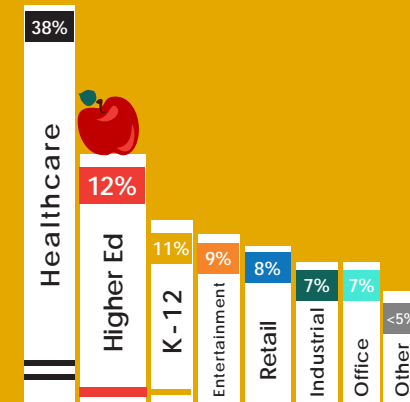

PERCENT OF VOLUME BY MARKET SEGMENT

ALEXANDER

ALEXANDER BUILDING CONSTRUCTION CO.

Harrisburg
315 Vaughn Street
Harrisburg, PA 17110
717-234-7041

State College
2545 N. Atherton Street
Suite 103
State College, PA 16803
814-237-6059

ALVIN H. BUTZ

ALVIN H. BUTZ, INC.

840 W. Hamilton Street
Suite 600
Allentown, PA 18101
610-395-6871

SHOEMAKER

SHOEMAKER CONSTRUCTION CO.

110 Washington Street
Suite 530
Conshohocken, PA 19428
610-941-5500

butz.com

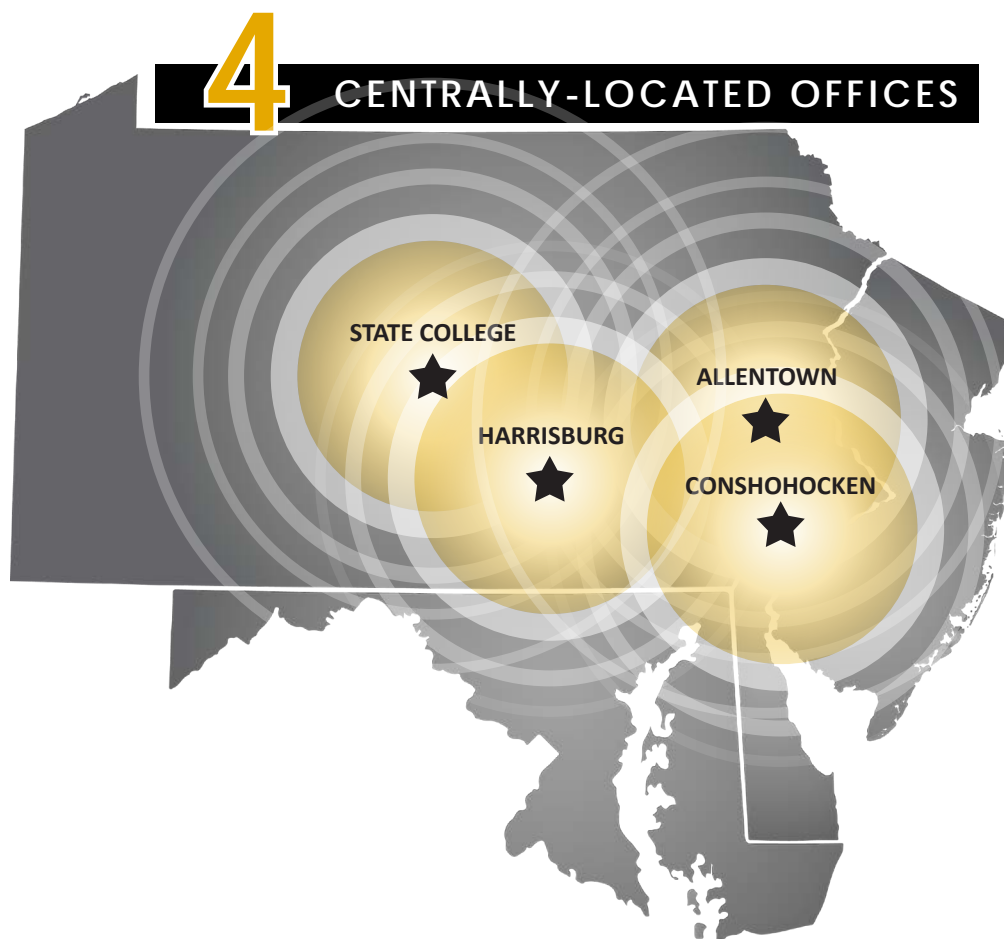

SAFETY
OUR GOAL:

ZERO
Personal Injury.

ZERO
Property Damage.

2024 PA EMR
.627

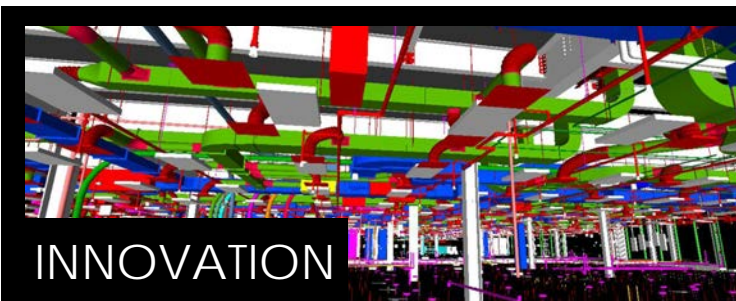

10-YEAR K-12 EDUCATION VOLUME
\$446M

44 PROJECTS LAST TEN YEARS
14 SCHOOL DISTRICTS
6 CHARTER SCHOOLS

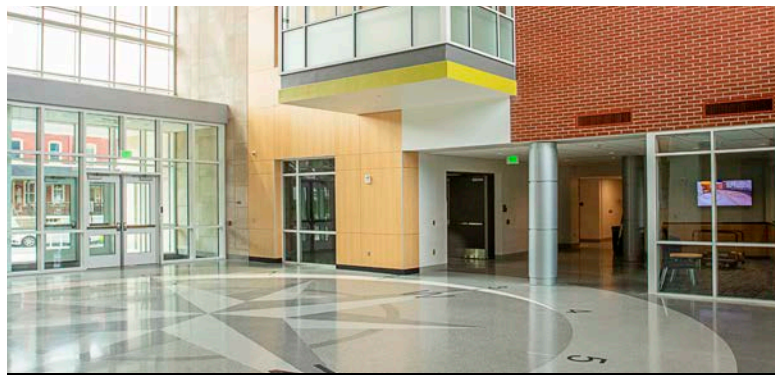

HAYS ELEMENTARY \$40.7M
 ALLENTOWN SCHOOL DISTRICT



WILLIAM ALLEN H.S. ADD/RENO \$74.4M
 ALLENTOWN SCHOOL DISTRICT



SDP - LEWIS C. CASSIDY ACADEMIC PLUS \$57.9M
 PHILADELPHIA INDUSTRIAL DEVELOPMENT CORP.



VETERANS MEMORIAL ELEMENTARY \$41.3M
 PARKLAND SCHOOL DISTRICT



FERGUSON TOWNSHIP ELEMENTARY \$19.6M
 STATE COLLEGE AREA SCHOOL DISTRICT



MOUNT NITTANY ELEMENTARY \$19.3M
 STATE COLLEGE AREA SCHOOL DISTRICT



ROOSEVELT ELEMENTARY ADD/RENO \$18.9M
 ALLENTOWN SCHOOL DISTRICT



RENOVATION & EXPANSION
LEHIGH VALLEY ACADEMY CHARTER SCHOOL
 \$45.9M



HIGH SCHOOL RENOVATION & EXPANSION
FOUNDATION ACADEMY CHARTER SCHOOL
 \$12.2M

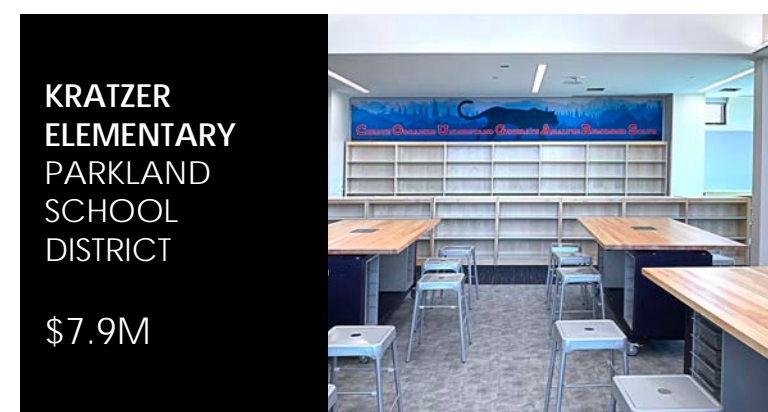

KRATZER ELEMENTARY \$7.9M
 PARKLAND SCHOOL DISTRICT

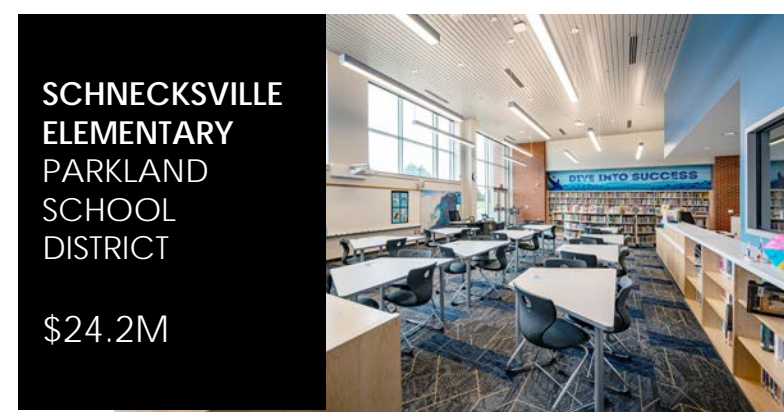

SCHNECKSVILLE ELEMENTARY \$24.2M
 PARKLAND SCHOOL DISTRICT



MULTIPLE PROJECTS \$112.6M
 HARRISBURG SCHOOL DISTRICT

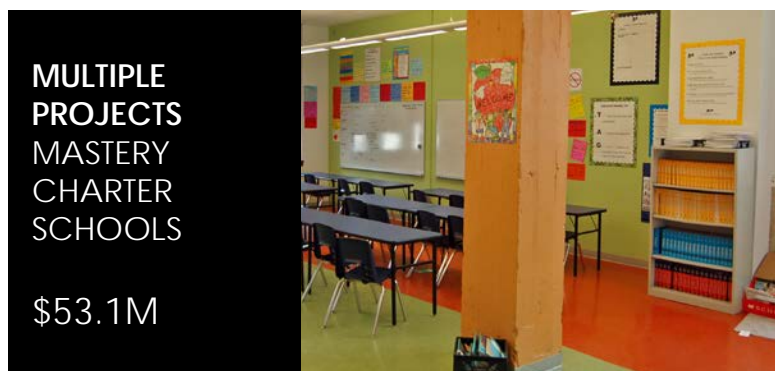

MULTIPLE PROJECTS \$53.1M
 MASTERY CHARTER SCHOOLS



SCHOOL RENOVATIONS & ADDITION \$16.3M
 COLUMBIA-MONTOUR AREA VO-TECH

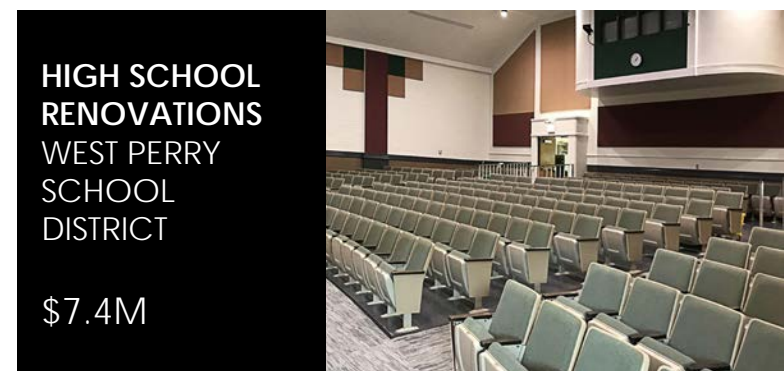

HIGH SCHOOL RENOVATIONS \$7.4M
 WEST PERRY SCHOOL DISTRICT